

| Legend | | | |
|--------|-----------------------------|--|----------------------|
| | New Arterial | | Existing Arterial |
| | New Collector / Access Road | | Existing Collector |
| | K-7 Mainline and Ramps | | City/County Boundary |
| | Proposed K-7 Right of Way | | Property Lines |
| | Overpass | | |

☪ K-10 ROW ~ 350'
 ☪ K-10 ROW ~ 300'
 ☪ K-10 ROW ~ 520'
 ☪ K-7 ROW ~ 640'
 ☪ K-7 ROW ~ 395'
 ☪ K-7 ROW ~ 310'
 ☪ K-7 ROW ~ 323'
 ☪ K-10 ROW ~ 570'
 ☪ K-10 ROW ~ 675'
 ☪ K-7 ROW ~ 582'
 ☪ K-7 ROW ~ 267'
 ☪ K-7 ROW ~ 240'
 ☪ K-7 ROW ~ 210'
 ☪ K-7 ROW ~ 225'
 ☪ K-7 ROW ~ 258'
 ☪ K-7 ROW ~ 271'
 ☪ K-7 ROW ~ 445'
 ☪ K-10 ROW ~ 522'
 ☪ K-10 ROW ~ 341'
 ☪ K-10 ROW ~ 340'
 ☪ K-10 ROW ~ 300'
 ☪ K-7 ROW ~ 582'
 ☪ K-10 ROW ~ 620'
 ☪ K-10 ROW ~ 350'

The K-10 Interchange was reviewed during the "K-10 Transportation Study" completed by HDR and HNTB in May 2005. The interchange was further studied as part of the "K-10 Interchanges Study" completed by HNTB and HDR in November 2006. The exhibit includes updates that were developed during these studies.

DISCLAIMER:
 These concepts are current as of May, 2013 and depict KDOT's recommended improvements for K-7 and the local street network from Spring Hill to Leavenworth. The exact location, design, and right-of-way for this project cannot be determined from these concepts and could be different from that shown. Additional preliminary design will need to be performed to further refine the improvements and right-of-way requirements.

HNTB

CITY OF OLATHE
 CITY OF LENEXA

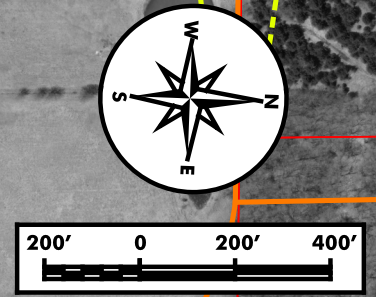

K-7 CORRIDOR STUDY
 K-10 Interchange
 Plate No. B-19
 Date of Aerials: 2010 June 2015