

South Central District Office
500 N. Hendricks
Hutchinson, KS 67504-0769



phone: 620-663-3361
fax: 620-663-1804
www.ksdot.org

Julie Lorenz, Secretary

Laura Kelly, Governor

IMMEDIATE RELEASE

May 4, 2022

For more information: Tim Potter

620-860-7389; mobile: 620-727-2278; Tim.Potter@ks.gov

Field survey is set for U.S. 281 bridge replacement in Barton County

A field survey will begin soon for a proposed bridge replacement over Blood Creek drainage on U.S. 281 in Barton County.

The proposed replacement would be about a third of a mile east of the west K-4/U.S. 281 junction. The approximate length of the survey is 3,000 feet, and the survey will be based on the existing alignment.

This field survey effort will begin around May 11 and is estimated to be completed by June 16.

The survey is to gather information for the detailed design of the proposed improvement.

A member of the survey crew first will contact property owners and/or tenants for permission to enter private property if needed. Survey activities will include the use of survey instruments on the ground to determine locations of existing features within the survey corridor.

Michael Selley, P.S., Survey Manager, KDOT, Bureau of Right of Way, will be in charge of this survey.

The map below shows the project location, circled.

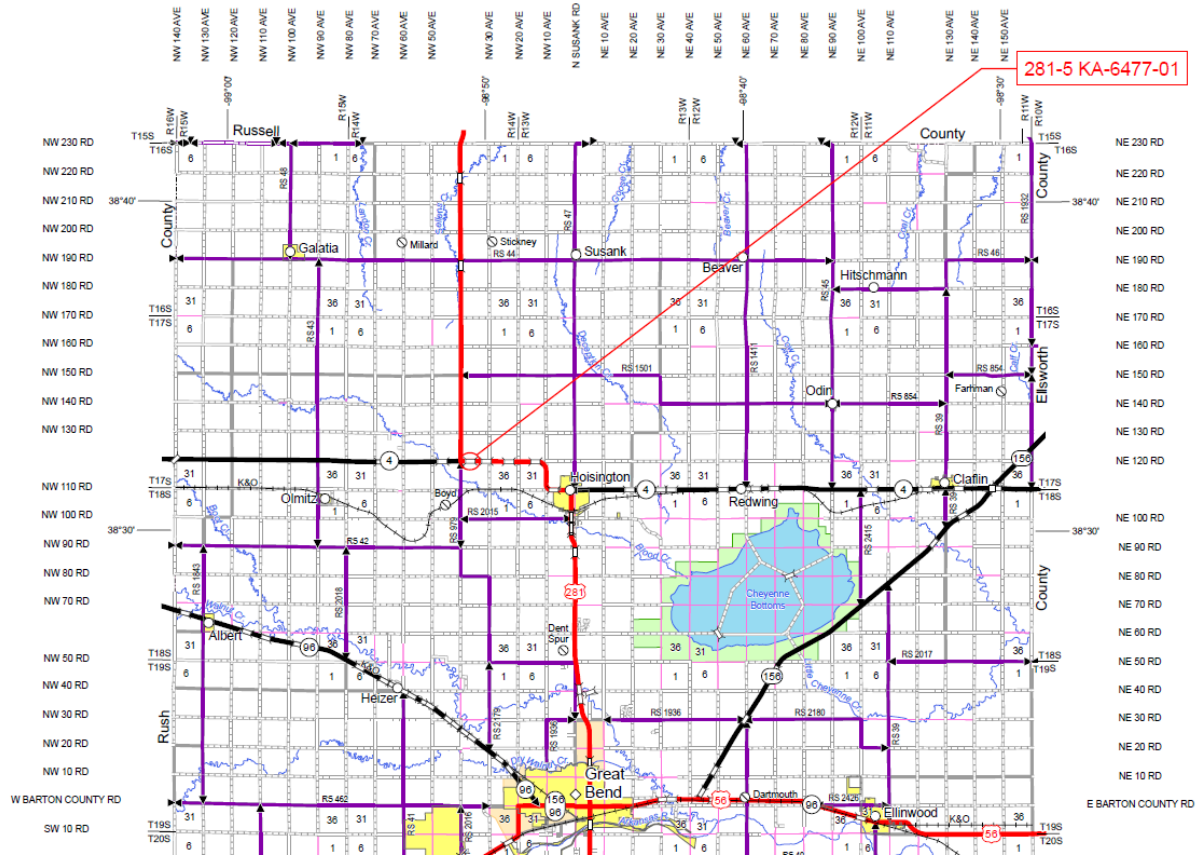

###

This information can be made available in alternative accessible formats upon request.

For information about obtaining an alternative format, contact the KDOT Communications Division, 700 SW Harrison St., 2nd Fl West, Topeka, KS 66603-3754 or phone 785-296-3585 (Voice)/Hearing Impaired – 711.

Click below to connect to KDOT’s Social Networks:

