

Southeast District Office  
411 W. Fourteenth  
Chanute, KS 66720-2894



phone: 620-902-6400  
fax: 620-431-4406  
[www.ksdot.org](http://www.ksdot.org)

Julie Lorenz, Secretary

Laura Kelly, Governor

## IMMEDIATE RELEASE

Oct. 3, 2022

**Contact:** Priscilla Petersen, (620) 902-6433; [priscilla.petersen@ks.gov](mailto:priscilla.petersen@ks.gov)

## Field survey to begin on K-99

The week of Oct. 10 the Kansas Department of Transportation (KDOT) plans to start a field survey at the Homer Creek drainage culvert on K-99 in Greenwood County. The culvert is 3 miles north of U.S. 54 (see map).

The survey area of 2,000 feet is based on the existing alignment. Survey crew members will gather information for a future culvert replacement project. KDOT expects the survey to be complete by Dec. 15.

Activities include the use of survey instruments on the ground to determine locations of existing features within the corridor. A member of the survey crew will contact property owners or tenants for permission to enter private property. Chuck Robinson of Schwab Eaton will manage the survey for KDOT. Persons with questions may contact KDOT Public Affairs Manager Priscilla Petersen, (620) 902-6433.

### Survey area, circled:

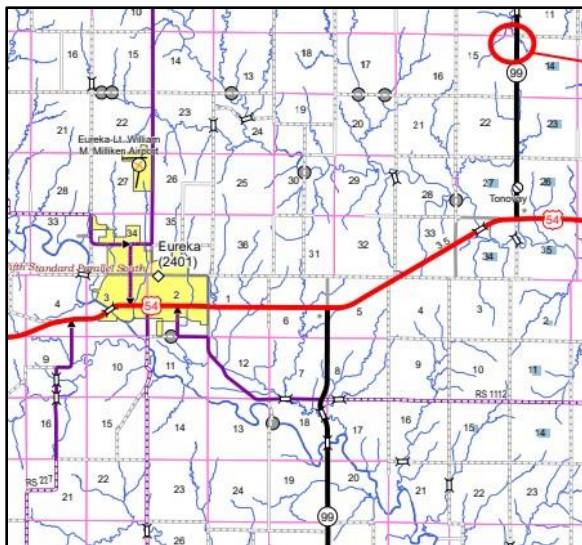

###

This information can be made available in alternative accessible formats upon request.  
For information about obtaining an alternative format, contact the KDOT Division of Communications,  
700 SW Harrison St., 2<sup>nd</sup> Fl West, Topeka, KS 66603-3754 or phone 785-296-3585 (Voice)/Hearing Impaired – 711.

Click below to connect to KDOT's Social Networks:

