

Southwest District Office  
121 N. Campus Drive  
Garden City, KS 67846



phone: 620-276-3241  
fax: 620-276-2333  
[www.ksdot.org](http://www.ksdot.org)

Julie Lorenz, Secretary

Laura Kelly, Governor

**June 3, 2021**  
**Lisa Knoll**  
**620.765.7080**  
[lisa.knoll@ks.gov](mailto:lisa.knoll@ks.gov)

## Survey work to begin in Ness County

Survey work for a proposed bridge replacement in Ness County is expected to begin Monday, June 7, according to the Kansas Department of Transportation.

The area being surveyed includes the Bazine Dry Creek bridge located on K-96 approximately 11.75 miles east of U.S. 283.

Chad Marsh with Kirkham Michael will lead this survey for the Kansas Department of Transportation.

A member of the survey crew will first contact property owners and/or tenants for permission to enter private property. Survey activities will include the use of survey instruments on the ground to determine locations of existing features within the survey corridor.

**The map below shows the project location marked by red arrows.**

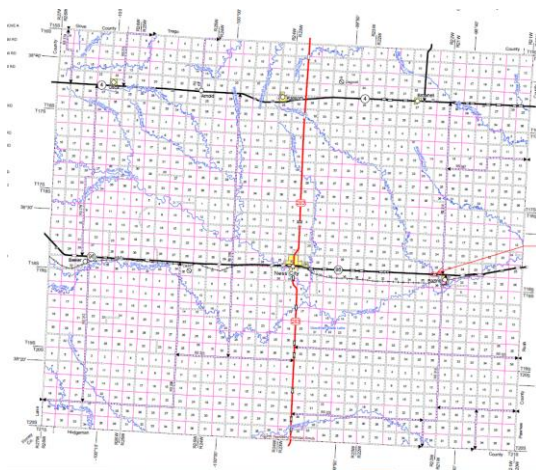

###

This information can be made available in alternative accessible formats upon request. For information about obtaining an alternative format, contact the KDOT Division of Communications, 700 SW Harrison St., 2nd Fl West, Topeka, KS 66603-3754 or phone 785-296-3585 (Voice)/Hearing Impaired – 711.

###

Click below to connect to KDOT's Social Networks:

