

LEGEND

<p>ROADS AND ROADWAY FEATURES</p> <ul style="list-style-type: none"> Primitive Road (Type A) Unimproved Road (Type B) Graded and Drained Road (Type C) Soil Surfaced Road (Type D) Gravel or Stone Road Not Graded or Drained (Type E-1) Gravel or Stone Road Graded and Drained (Type E-2) Gravel or Stone Road With Stabilized Surface (Type E-3) Bituminous Road-Low Type (Type F, G-1, H-1) Paved Road (Type G-2, I, J, K, L) Divided Highway Highway With Full Control of Access Side Roads and Streets in Unincorporated Urban Compact and Extensions of Local Roads Within Municipalities 4 Lane Undivided Highway Projected Road <p>Road System Designation</p> <ul style="list-style-type: none"> Federal-Aid Interstate Highway System Federal-Aid Primary Highway System Federal-Aid Secondary Highway System Federal-Aid Urban Highway System Points Between Which Distances are Milemarked Interstate Numbered Highway U.S. Numbered Highway State Highway System or State Numbered Highway End of Designated System or Marked Route <p>RAILROADS</p> <ul style="list-style-type: none"> Railroad Any Number of Tracks Used by a Single Operating Company or by Trains of Another Carrier Under Trackage Rights Railroads in Joint Operation (Two or More Tracks of Separately Owned Companies on Adjacent Rights-of-Way) Abandoned Railroads (Track Retained) Railroad Station Cemetery <p>Railroad Crossing</p> <ul style="list-style-type: none"> Grade Crossing Railroad Above Railroad Below Went Railroad Bridge <p>WAYS AND AIRPORTS</p> <ul style="list-style-type: none"> Military Field (Some Facilities Available) Airport Complete Facilities (Commercial or Municipal) Airfield, Limited Facilities Landing Area or Strip (Including Private Air Fields) Always Light Beacon, General Airport General <p>NAVIGATION</p> <ul style="list-style-type: none"> Navigable Stream (Non-intermittent navigation) <p>DRAINAGE</p> <ul style="list-style-type: none"> Intermittent Stream (Barrow) Intermittent Stream (Wide) Narrow Stream Wide Stream Drainage Ditch Irrigation Ditch Lake, Reservoir, or Pond Lake, Reservoir, or Pond With Dam Dry Lake Subject To Flood Martin or Swamp Land Overflow Land <p>STRUCTURES</p> <p>Highway Bridges</p> <ul style="list-style-type: none"> Highway Bridge, General (Total Span Greater Than 20 Feet) Small Bridges Closely Spaced <p>Bridges For Long River Crossings</p> <ul style="list-style-type: none"> General Arch Truss or Girder (w. wood s. steel) Cantilever Bridge Highway Grade Separation <p>Miscellaneous Structures</p> <ul style="list-style-type: none"> Level Or Dike Level Or Dike With Road Concrete Ford Or Di Ford Road Established Cattle Guard Gate Across Road (Any Type) <p>BOUNDARIES</p> <ul style="list-style-type: none"> State County Corporate Lines Boundary Lines Established For Delimited Urban Places Section Line Boundary in Mark Enlargement Inset Parks and Other Reservations National, State, County, or Municipal Park, Indian Reservation, National Monument, Federal Development Project Monument-Stat. Historic Site <p>CITY AND VILLAGE CENTERS</p> <ul style="list-style-type: none"> State Capital Incorporated City or Village Other Cities and Villages Incorporated City or Village Boundary Lines Fixed for Special Taxing Areas and Other Unincorporated Urban Places Designated <p>NATURAL FEATURES</p> <ul style="list-style-type: none"> Prominent Elevation-With Name (Numerals Indicate Elevation Above Sea Level) Sink or Depression 	<p>CONSERVATION AND RECREATION</p> <ul style="list-style-type: none"> Picnic Ground Playground, Ball Field, Etc. Bathing Beach or Swimming Pool Scenic Site Camp Site, No Permanence (Tents or Trailer Parking) Number of Permanent Cabins or Cottages Camp or Lodge (Permanent Site With Building) Small Park (SP-State, CH-County, MP-Municipal, SR-Survey, Rest Area) State Park (SP-State, CH-County, MP-Municipal, SR-Survey, Rest Area) Game Preserve Rifle Club Gun Ground or County Club Riding Academy Yacht Club Amusement Park or Hall Fair Ground, Race Course, Speedway Drive-In Theatre Marine Rocket Grounds Gunite House or Gate House (Add Letters N or S to Indicate National or State Park) <p>FARM UNITS, DWELLINGS, ETC.</p> <ul style="list-style-type: none"> Farm Unit Dwelling (Other Than Farm) Roads or Groups of Dwellings Closely Spaced (Figure Denotes Number of Dwellings) Combined Dwelling and Store Dwelling and Post Office Dwelling, Business, and Filling Station Transient House Seasonal or Summer Colony Dwelling Hotel, Inn Humane Society Quarters Church or Other Religious Institution Church and School (Joint Use) Cemetery Church With Cemetery Adjacent Fresh Air Farm or Rest Home Hospital State Park of Entry or Weight Station Group of Most Cultural Facilities Closely Spaced (Figure above bar indicates number of dwellings included in the group. Figures over individual units show number of each included regardless of order) <p>INDUSTRIAL</p> <ul style="list-style-type: none"> Store or Small Business Establishment Business and Filling Station Business, Filling Station, and Post Office Factory or Industrial Plant Mine-Shaft or Drill (Any Kind) Oil or Gas Well Oil or Gas Field Storage Tank (Gas or Oil Figure Denotes Number of Tanks) Filling Station (Not Combined With Other Business) Pumping Station (Oil or Gas) Gauging or Pumping Station (General) Valve House Seasonal Industry (Cannery or Small Grain Mill) Milk Depot, Creamery or Cheese Factory Fruit or Nut Orchard Fruit or Produce Packing House Road Stand Farm Product Sales Warehouse-General (If Government Add State or U.S.) Grain Elevator Group of Grain Storage Bins Greenhouse Nursery Stock Yard-Loading Pen or Corral Stock Pen at Railroad Station (Small) Gravel Pit Quarry Kiln or Oven (Lime, Clay Products, Coke, Etc.) Fuel Lot Shopping Center Seasonal Business Sawmill (Stationary) <p>EDUCATIONAL AND CORRECTIONAL INSTITUTIONS</p> <ul style="list-style-type: none"> Schoolhouse Consolidated or Large School Tramway, Garage, or Community Hall Agricultural Experiment Station Correctional Institution Museum-General Public Library <p>PUBLIC SERVICE FACILITIES</p> <ul style="list-style-type: none"> Post Office Highway Garage Fire Engine House Garbage or Rubbish Dump Sewage Disposal Plant Auto Salvage Yard Transformer Station Power Plant Power Substation Booster Station Water Supply, Stand Pipe or Tank Radio Station (With Call Letters) Radio Range Station Water Treatment Plant Juryroad U.S. Corps of Engineers Office <p>MISCELLANEOUS</p> <ul style="list-style-type: none"> Fort, Army Camp, Barracks, or Other Military Post Transmutation Station Branch Main (Water System)
--	---

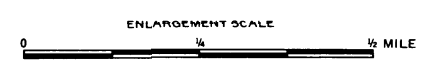
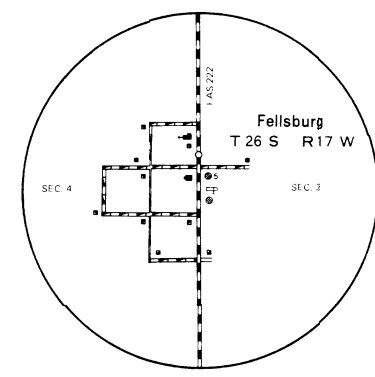
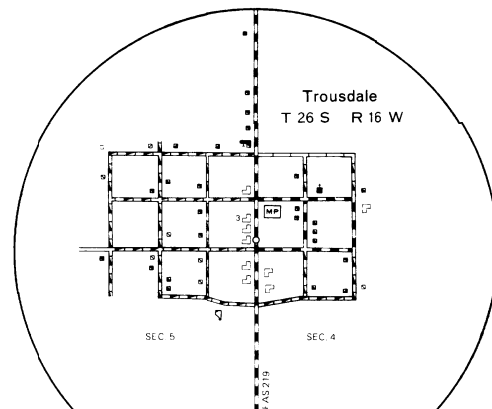

**GENERAL HIGHWAY MAP
EDWARDS COUNTY
KANSAS**

PREPARED BY THE
**KANSAS DEPARTMENT OF TRANSPORTATION
PLANNING AND DEVELOPMENT DEPARTMENT**
IN COOPERATION WITH THE
**U. S. DEPARTMENT OF TRANSPORTATION
FEDERAL HIGHWAY ADMINISTRATION**

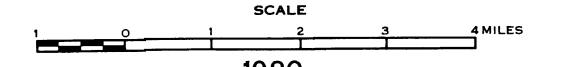

1980
POLYCONIC PROJECTION

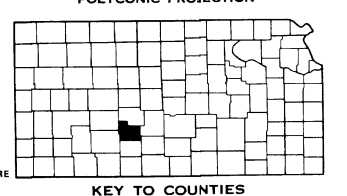

POPULATIONS - STATE BOARD OF AGRICULTURE
1970 CENSUS
PRELIMINARY COMPLETED
F. A. AND STATE
SYSTEMS REVISED TO

KEY TO COUNTIES
EDWARDS COUNTY
1:500,000 SCALE
U.S. GEOLOGICAL SURVEY