

CITY OF
RANSOM
NESS COUNTY, KANSAS

T 16 S R 23 W R 24 W

13 PREPARED BY THE

**KANSAS DEPARTMENT OF TRANSPORTATION
BUREAU OF TRANSPORTATION PLANNING**

IN COOPERATION WITH THE
**U.S. DEPARTMENT OF TRANSPORTATION
FEDERAL HIGHWAY ADMINISTRATION**

SCALE

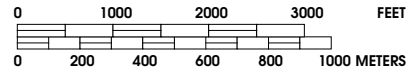

OCTOBER, 2003

POP. 322

POPULATION - U.S. BUREAU OF THE CENSUS 2000
CERTIFIED TO SECRETARY OF STATE, 7/1/2003

PROJECTION - LAMBERT CONFORMAL CONIC
KANSAS COORDINATE SYSTEM, NORTH ZONE

SOURCE - 7.5' U.S.G.S. QUADRANGLE (1:24,000 SCALE)
KDOT makes no warranties, guarantees, or representations for accuracy of this information and assumes no liability for errors or omissions.

- LEGEND**
- CORPORATE CITY LIMITS
 - LAND SECTION LINE
 - DIVIDED HIGHWAY
 - STATE HIGHWAY
 - STREET OR PUBLIC ROAD
 - RAILROAD
 - INTERSTATE NUMBERED ROUTE
 - U.S. NUMBERED ROUTE
 - STATE NUMBERED ROUTE
 - SCHOOL
 - HOSPITAL
 - CITY HALL
 - MUSEUM
 - CUL-DE-SAC
 - POST OFFICE
 - KDOT OFFICE
 - SPORTS COMPLEX
 - COUNTY COURT HOUSE
 - LOW WATER CROSSING



T 16 S

T 16 S

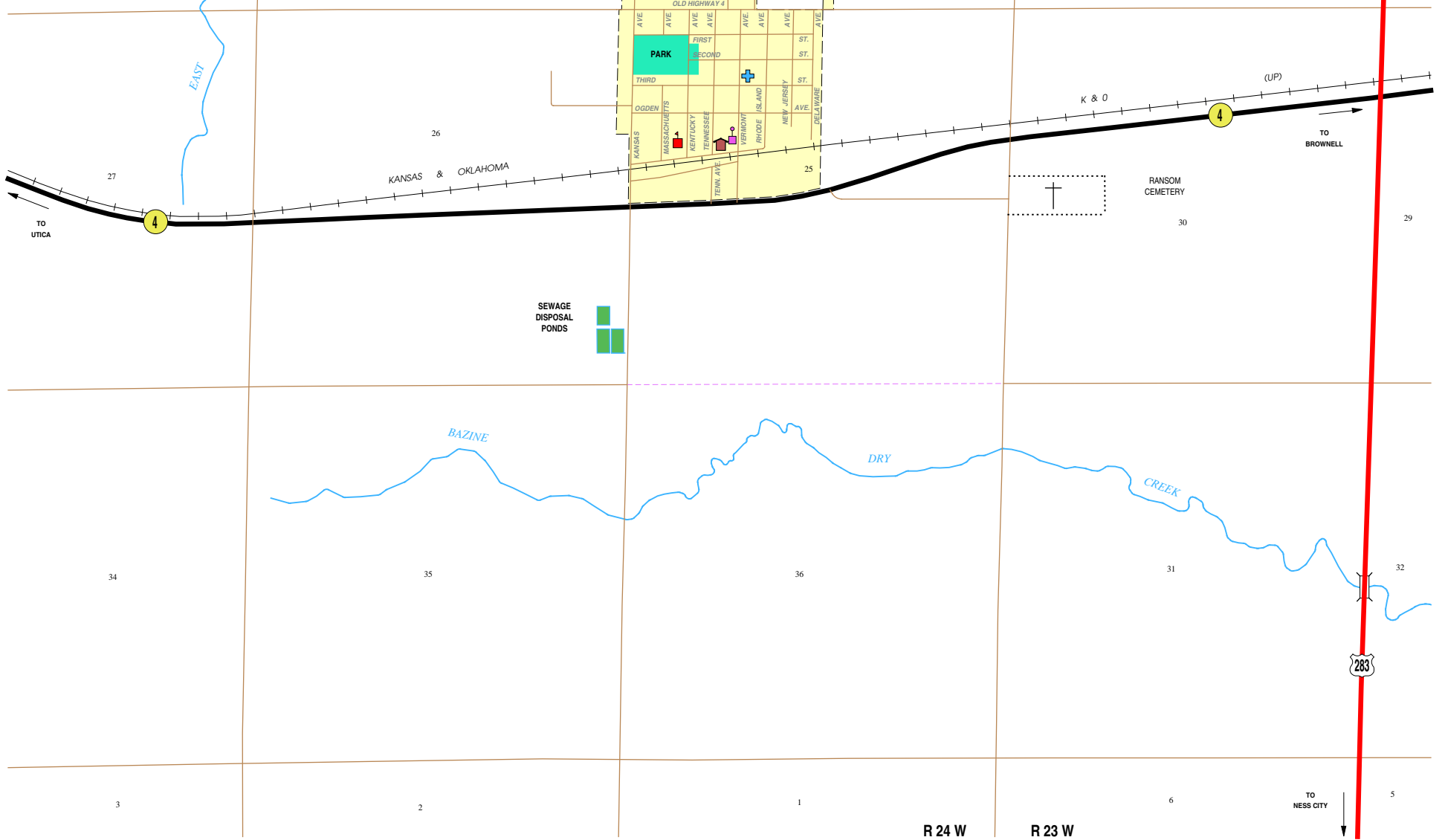

TO WAKEENEY

TO BROWNELL

TO NESS CITY

RANSOM #488

RANSOM #488