

CITY OF BROOKVILLE

SALINE COUNTY KANSAS

T 14 S, T 15 S, R 5 W

PREPARED BY THE

KANSAS DEPARTMENT OF TRANSPORTATION
BUREAU OF TRANSPORTATION PLANNING

IN COOPERATION WITH THE
U.S. DEPARTMENT OF TRANSPORTATION
FEDERAL HIGHWAY ADMINISTRATION

SCALE

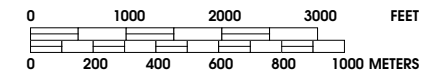

FEBRUARY, 2003

POP. 257

POPULATION - U.S. BUREAU OF THE CENSUS 2000
CERTIFIED TO SECRETARY OF STATE, 7/1/2002

PROJECTION - LAMBERT CONFORMAL CONIC
KANSAS COORDINATE SYSTEM, NORTH ZONE

SOURCE - 7.5' U.S.G.S. QUADRANGLE (1:24,000 SCALE)
KDOT makes no warranties, guarantees, or representations for accuracy
of this information and assumes no liability for errors or omissions.

T 14 S
T 15 S

T 14 S
T 15 S

R 5 W

R 5 W

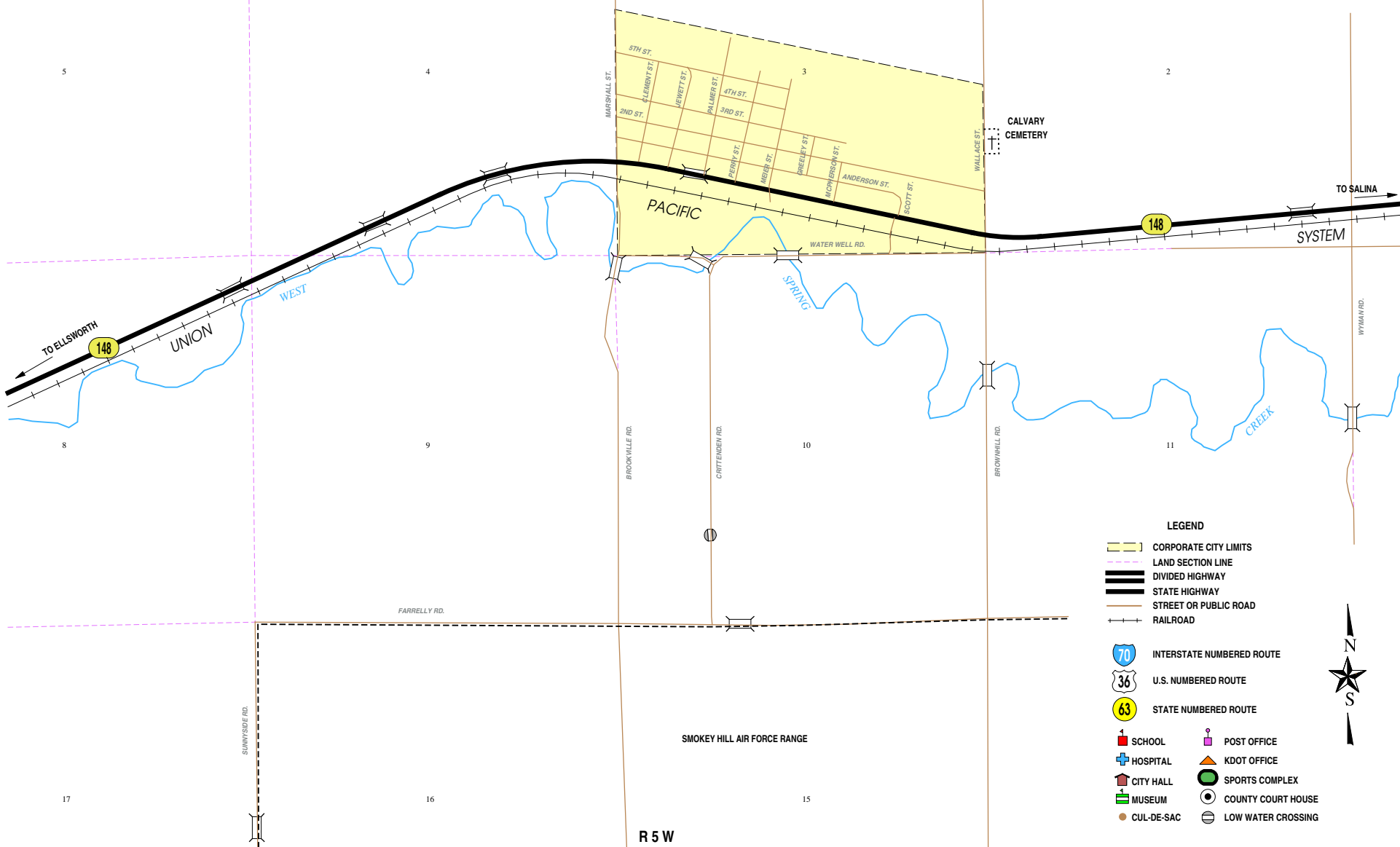

LEGEND

- CORPORATE CITY LIMITS
- LAND SECTION LINE
- DIVIDED HIGHWAY
- STATE HIGHWAY
- STREET OR PUBLIC ROAD
- RAILROAD
- INTERSTATE NUMBERED ROUTE
- U.S. NUMBERED ROUTE
- STATE NUMBERED ROUTE
- SCHOOL
- HOSPITAL
- CITY HALL
- MUSEUM
- CUL-DE-SAC
- POST OFFICE
- KDOT OFFICE
- SPORTS COMPLEX
- COUNTY COURT HOUSE
- LOW WATER CROSSING

