

R 14 E

T 18 S  
OSAGE COUNTY  
T 19 S  
COFFEY COUNTY

OSAGE COUNTY  
T 18 S  
COFFEY COUNTY  
T 19 S

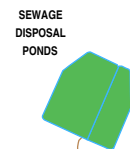
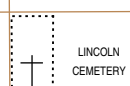
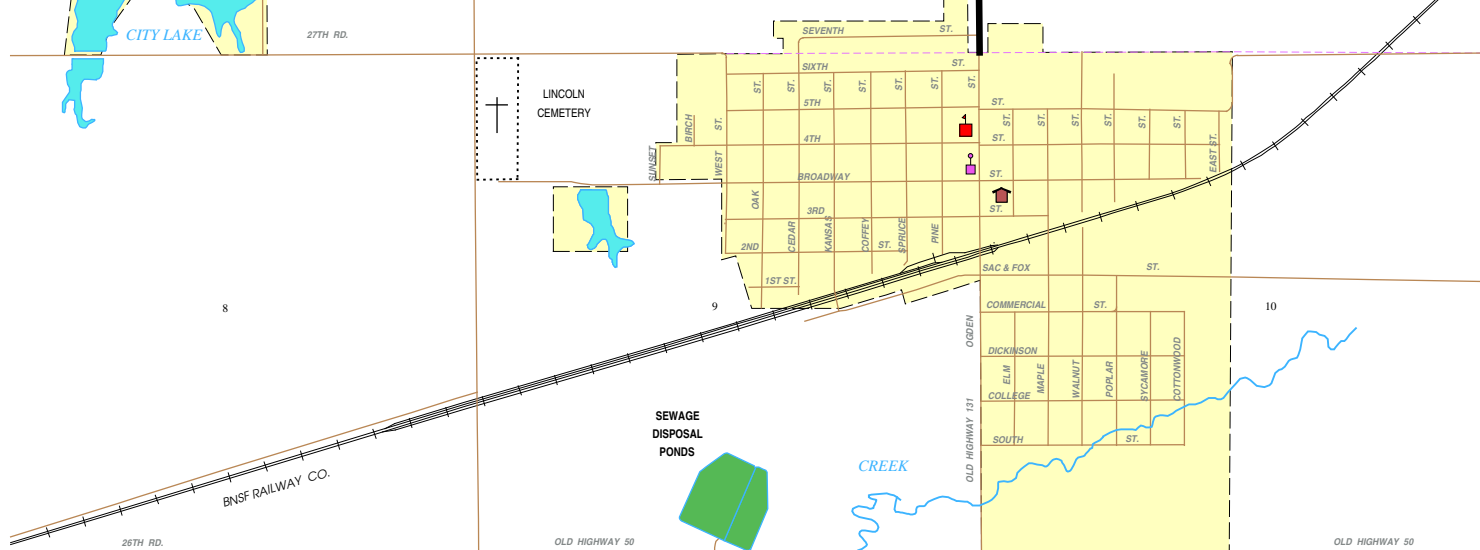
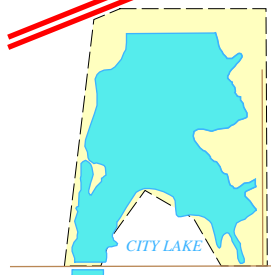
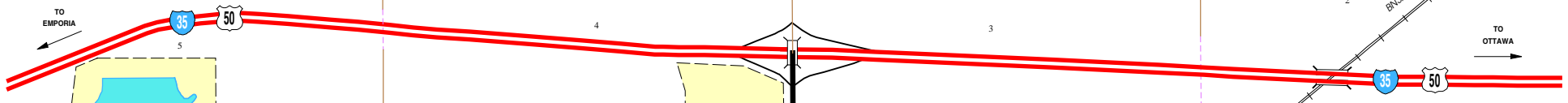

LEBO CREEK

- LEGEND**
- CORPORATE CITY LIMITS
  - LAND SECTION LINE
  - DIVIDED HIGHWAY
  - STATE HIGHWAY
  - STREET OR PUBLIC ROAD
  - RAILROAD
  - INTERSTATE NUMBERED ROUTE
  - U.S. NUMBERED ROUTE
  - STATE NUMBERED ROUTE
  - SCHOOL
  - POST OFFICE
  - HOSPITAL
  - KDOT OFFICE
  - CITY HALL
  - SPORTS COMPLEX
  - MUSEUM
  - COUNTY COURT HOUSE
  - CUL-DE-SAC
  - LOW WATER CROSSING



# CITY OF LEBO

COFFEY COUNTY KANSAS

T 18 S, T 19 S, R 14 E

PREPARED BY THE  
KANSAS DEPARTMENT OF TRANSPORTATION  
BUREAU OF TRANSPORTATION PLANNING

IN COOPERATION WITH THE  
U.S. DEPARTMENT OF TRANSPORTATION  
FEDERAL HIGHWAY ADMINISTRATION

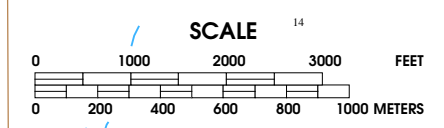

AUGUST, 2006  
POP. 957

POPULATION - U.S. BUREAU OF THE CENSUS 2000  
CERTIFIED TO SECRETARY OF STATE, 7/1/2005

PROJECTION - LAMBERT CONFORMAL CONIC  
KANSAS COORDINATE SYSTEM, NORTH ZONE

SOURCE - 7.5' U.S.G.S. QUADRANGLE (1:24,000 SCALE)  
KDOT makes no warranties, guarantees, or representations for accuracy of this information and assumes no liability for errors or omissions.

JORDAN

R 14 E