

R 5 W R 4 W

CITY OF
REPUBLIC
REPUBLIC COUNTY KANSAS

T 1-2 S, R 4-5 W

PREPARED BY THE
KANSAS DEPARTMENT OF TRANSPORTATION
BUREAU OF TRANSPORTATION PLANNING
IN COOPERATION WITH THE
U.S. DEPARTMENT OF TRANSPORTATION
FEDERAL HIGHWAY ADMINISTRATION

SCALE

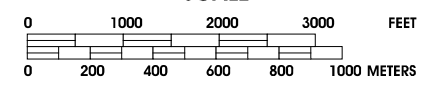

JANUARY, 2002
POP. 161

POPULATION - U.S. BUREAU OF THE CENSUS 2000
PROJECTION - LAMBERT CONFORMAL CONIC
KANSAS COORDINATE SYSTEM, NORTH ZONE
SOURCE - 7.5' U.S.G.S. QUADRANGLE (1:24,000 SCALE)

KDOT makes no warranties, guarantees, or representations for accuracy of this information and assumes no liability for errors or omissions.

SEWAGE DISPOSAL
PONDS

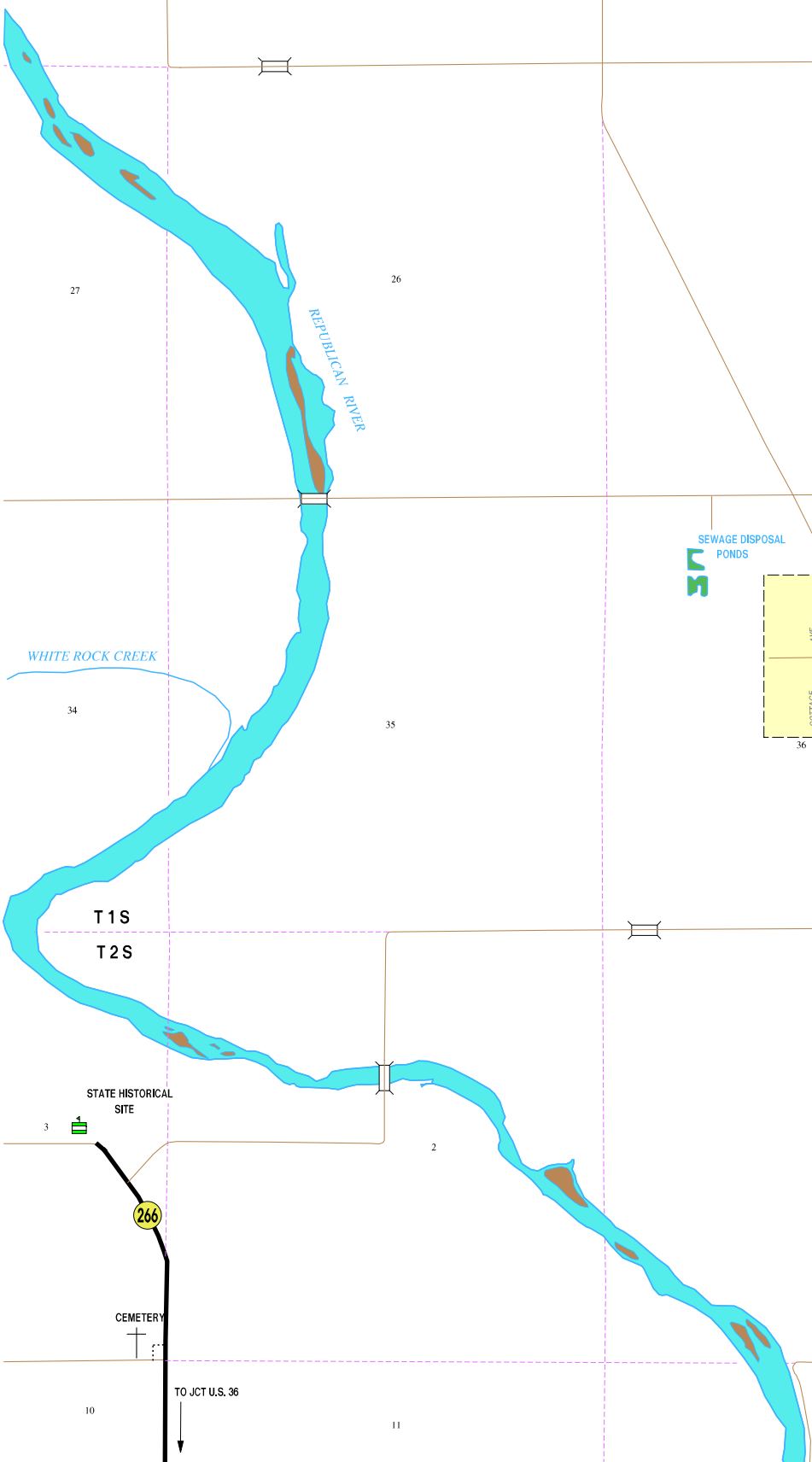
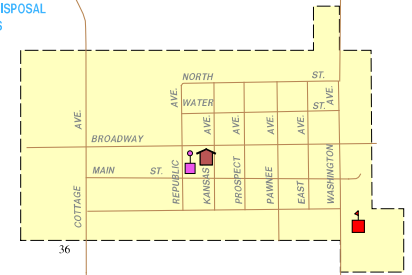

T 1 S
T 2 S

T 1 S
T 2 S

R 5 W R 4 W

LEGEND

- CORPORATE CITY LIMITS
- LAND SECTION LINE
- DIVIDED HIGHWAY
- STATE HIGHWAY
- STREET OR PUBLIC ROAD
- RAILROAD
- INTERSTATE NUMBERED ROUTE
- U.S. NUMBERED ROUTE
- STATE NUMBERED ROUTE
- SCHOOL
- HOSPITAL
- CITY HALL
- MUSEUM
- POST OFFICE
- KDOT OFFICE
- SPORTS COMPLEX
- COUNTY COURT HOUSE



STATE HISTORICAL SITE

266

CEMETERY

TO JCT U.S. 36