

R 14 E

T 18 S
OSAGE COUNTY
T 19 S
COFFEY COUNTY

OSAGE COUNTY
COFFEY COUNTY
T 18 S
T 19 S

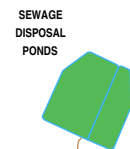
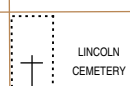
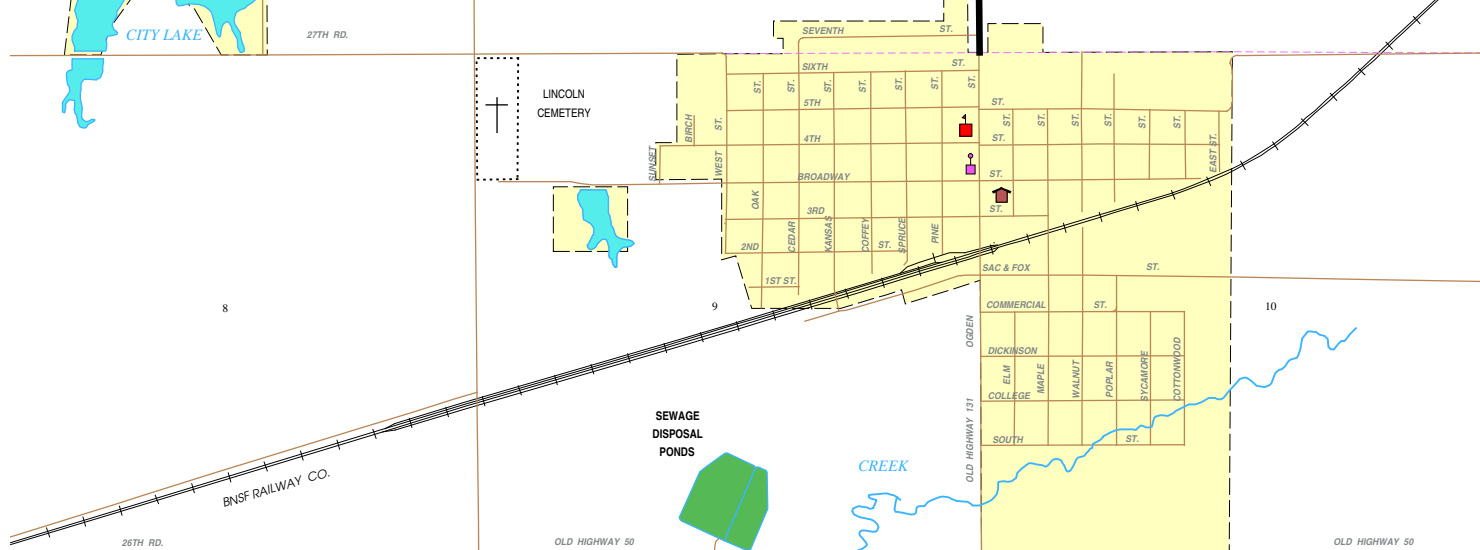
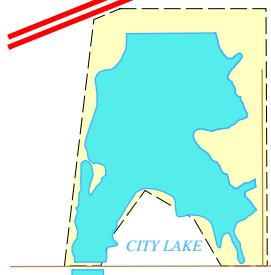
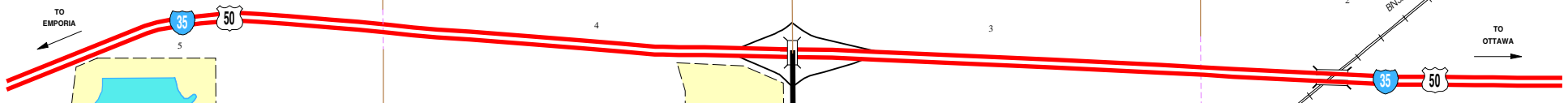

LEBO CREEK

- LEGEND**
- CORPORATE CITY LIMITS
 - LAND SECTION LINE
 - DIVIDED HIGHWAY
 - STATE HIGHWAY
 - STREET OR PUBLIC ROAD
 - RAILROAD
 - INTERSTATE NUMBERED ROUTE
 - U.S. NUMBERED ROUTE
 - STATE NUMBERED ROUTE
 - SCHOOL
 - POST OFFICE
 - HOSPITAL
 - KDOT OFFICE
 - CITY HALL
 - SPORTS COMPLEX
 - MUSEUM
 - COUNTY COURT HOUSE
 - CUL-DE-SAC
 - LOW WATER CROSSING



CITY OF
LEBO
COFFEY COUNTY KANSAS

T 18 S, T 19 S, R 14 E

PREPARED BY THE
KANSAS DEPARTMENT OF TRANSPORTATION
BUREAU OF TRANSPORTATION PLANNING
IN COOPERATION WITH THE
U.S. DEPARTMENT OF TRANSPORTATION
FEDERAL HIGHWAY ADMINISTRATION

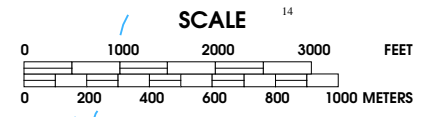

AUGUST, 2006
POP. 957

POPULATION - U.S. BUREAU OF THE CENSUS 2000
CERTIFIED TO SECRETARY OF STATE, 7/1/2005
PROJECTION - LAMBERT CONFORMAL CONIC
KANSAS COORDINATE SYSTEM, NORTH ZONE
SOURCE - 7.5' U.S.G.S. QUADRANGLE (1:24,000 SCALE)
KDOT makes no warranties, guarantees, or representations for accuracy of this information and assumes no liability for errors or omissions.

JORDAN

R 14 E