

CITY OF LEWIS

EDWARDS COUNTY, KANSAS

T 24 S, T 25 S, R 17 W, R 18 W

PREPARED BY THE
KANSAS DEPARTMENT OF TRANSPORTATION
BUREAU OF TRANSPORTATION PLANNING

IN COOPERATION WITH THE
U.S. DEPARTMENT OF TRANSPORTATION
FEDERAL HIGHWAY ADMINISTRATION

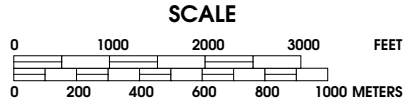

NOVEMBER, 2005
POP. 476

POPULATION - U.S. BUREAU OF THE CENSUS 2000
CERTIFIED TO SECRETARY OF STATE, 7/1/2005
PROJECTION - LAMBERT CONFORMAL CONIC
KANSAS COORDINATE SYSTEM, NORTH ZONE

SOURCE - 7.5' U.S.G.S. QUADRANGLE (1:24,000 SCALE)
KDOT makes no warranties, guarantees, or representations for accuracy of this information and assumes no liability for errors or omissions.

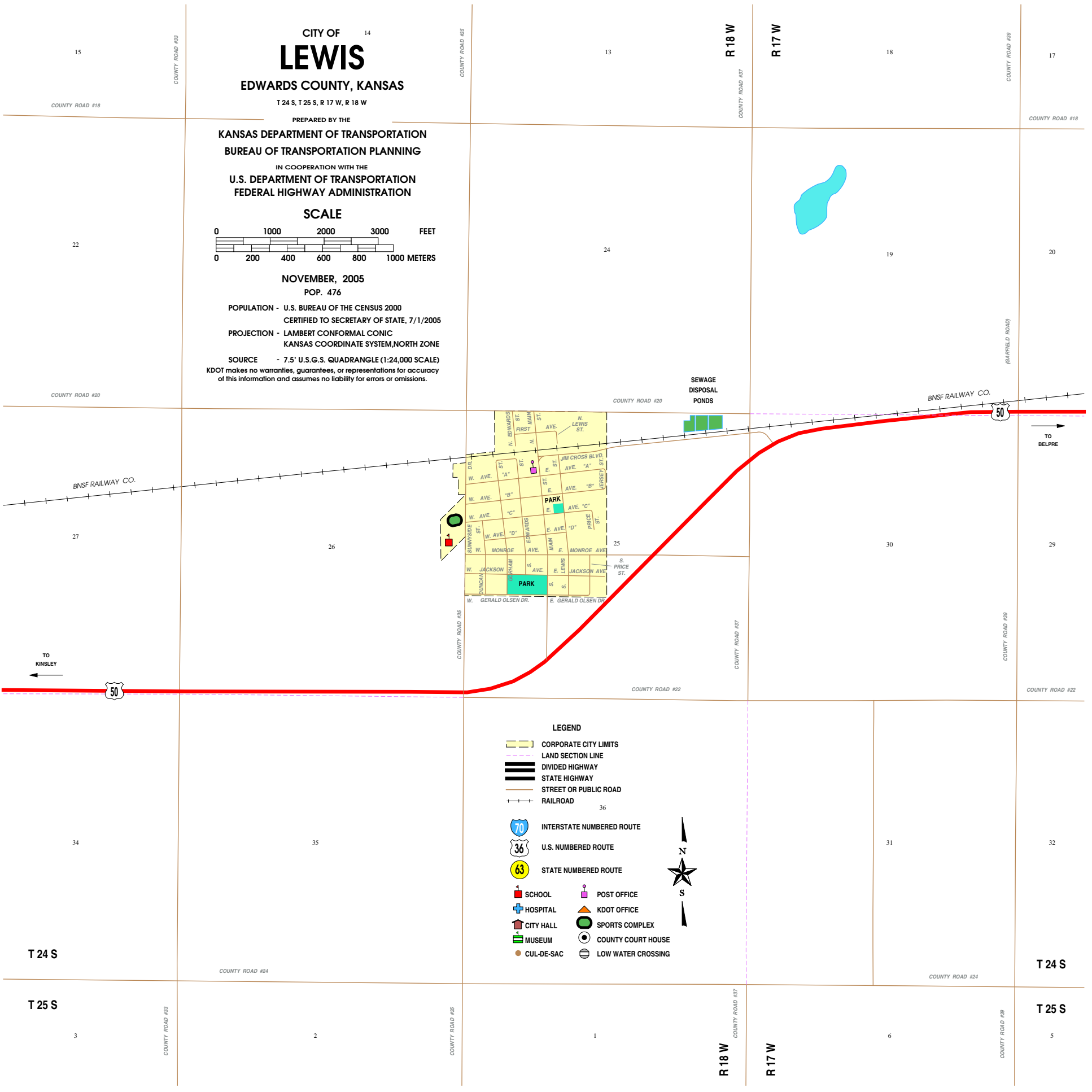

- LEGEND**
- CORPORATE CITY LIMITS
 - LAND SECTION LINE
 - DIVIDED HIGHWAY
 - STATE HIGHWAY
 - STREET OR PUBLIC ROAD
 - RAILROAD
 - INTERSTATE NUMBERED ROUTE
 - U.S. NUMBERED ROUTE
 - STATE NUMBERED ROUTE
 - SCHOOL
 - HOSPITAL
 - CITY HALL
 - MUSEUM
 - CUL-DE-SAC
 - POST OFFICE
 - KDOT OFFICE
 - SPORTS COMPLEX
 - COUNTY COURT HOUSE
 - LOW WATER CROSSING



T 24 S

T 25 S

T 24 S

T 25 S