

LEGEND

ROADS AND ROADWAY FEATURES	CONSERVATION AND RECREATION
PRIMITIVE ROAD TYPE 1	PICNIC GROUND
UNIMPROVED ROAD TYPE 2	PLAYGROUND, BALL FIELD, ETC.
GRADED AND DRAINED ROAD TYPE 3	BATHING BEACH OR SWIMMING POOL
SOIL SURFACED ROAD TYPE 4	SCENIC SITE
GRAVEL OR STONE ROAD NOT GRADED OR DRAINED TYPE 5	CAMP SITE, NO PERMANENCE (TENTS OR TRAILER PARKING)
GRAVEL OR STONE ROAD GRADED AND DRAINED TYPE 6	TOURIST ROUTE OR MOTEL
GRAVEL OR STONE ROAD WITH STABILIZED SURFACE TYPE 7	CAMP OR LODGE (PERMANENT SITE WITH BUILDINGS)
BITUMINOUS ROAD-LOW TYPE TYPE 8	SMALL PARK
PAVED ROAD TYPE 9	FISH HATCHERY
DIVIDED HIGHWAY TYPE 10	BIRD SANCTUARY
SIDE ROADS AND STREETS IN URBAN PORTIONED URBAN COMPACTS AND EXTENSIONS OF LOCAL ROADS WITHIN MUNICIPALITIES	GAME FARM
4 LANE UNDIVIDED HIGHWAY	GAME PRESERVE
FEDERAL-AID PRIMARY HIGHWAY SYSTEM	RIFLE CLUB
FEDERAL-AID SECONDARY HIGHWAY SYSTEM	GOLF GROUND OR COUNTRY CLUB
FEDERAL-AID URBAN HIGHWAY SYSTEM	POLO GROUNDS
STATE-AID ROAD	RIDING ACADEMY
POINTS BETWEEN WHICH DISTANCES ARE MEASURED INDICATED THUS	YACHT CLUB
TRAFFIC CIRCLE	AMUSEMENT PARK OR HALL
CLOVER LEAF	DRIVE-IN THEATRE
U.S. NUMBERED HIGHWAY	FARM UNITS, DWELLINGS, ETC.
STATE HIGHWAY SYSTEM OR STATE NUMBERED HIGHWAY	FARM UNIT
END OF DESIGNATED SYSTEM OR MARKED ROUTE	DWELLING (OTHER THAN FARM)
RAILROADS	ROWS OR GROUPS OF DWELLINGS CLOSELY SPACED (FIGURE SHOWS NUMBER OF DWELLINGS)
RAILROAD (TYPE OF TRACKS USED BY A RAILROAD INDICATED BY SYMBOL)	COMBINED DWELLING AND STORE
RAILROADS IN JUNCTURE POSITION (TOP OR BOTTOM TRACKS)	DWELLING AND FILLING STATION
NARROW GAUGE RAILROAD	DWELLING, BUSINESS, AND FILLING STATION
ELECTRIC INTERURBAN OR SUBURBAN RAILROAD	TENANT HOUSE
ABANDONED RAILROAD (TRACK REMOVED)	SEASONAL OR SUMMER COLONY DWELLING
ABANDONED ELECTRIC LINE (TRACK REMOVED)	HOTEL, INN
RAILROAD STATION	CHURCH OR OTHER RELIGIOUS INSTITUTION
RAILROAD CROSSINGS	CHURCH AND SCHOOL (LIGHT USE)
STANDARD GAUGE RAILROAD	CHURCH WITH CEMETERY ADJACENT
ELECTRIC RAILROAD	CEMETERY
AIRWAYS AND AIRPORTS	HOSPITAL
AIR ROUTE	WELL
MILITARY FIELD (SOME FACILITIES AVAILABLE)	STATE PORT OF ENTRY OR WEIGHT STATION
AIRPORT, COMPLETE FACILITIES (OPERATIONAL OR NON-OPERATIONAL)	GROUP OF MIXED CULTURAL FEATURES CLOSELY SPACED (INDICATED BY THE FIGURE - STATES NUMBER OF FEATURES)
AIRFIELD, LIMITED FACILITIES	INDUSTRIAL
LANDING AREA OR STRIP (INCLUDING HEAVY AIR FIELD)	STORE OR SMALL BUSINESS ESTABLISHMENT
AIRWAY LIGHT BEACON, GENERAL	BUSINESS AND POST OFFICE
AIRPORT, GENERAL	BUSINESS, FILLING STATION, AND POST OFFICE
NAVIGABLE STREAM (WATERWAY)	FACTORY OR INDUSTRIAL PLANT
INTERMITTENT STREAM	MINE-SHAFT OR DRIFT (SEE NOTE)
WIDE STREAM	OIL OR GAS WELL
DRAINAGE DITCH	OIL OR GAS FIELD
LAKE, RESERVOIR, OR POND WITH DAM	GAS TANK
LAKE, RESERVOIR, OR POND	GROUP OF STORAGE TANKS (OIL OR GAS)
DRY LAKE SUBJECT TO FLOOD	FILLING STATION (SEE NOTE)
MARSH OR SWAMP LAND	PUMPING STATION (OIL OR GAS)
OVERFLOW LAND	GAUGING OR PUMPING STATION - GENERAL
STRUCTURES	VALVE HOUSE
HIGHWAY BRIDGE, GENERAL	SEASONAL INDUSTRY (CONCRETE OR SMALL DAM WALL)
SMALL BRIDGES CLOSELY SPACED	FRUIT OR NUT ORCHARD
GENERAL	ROAD STAND FARM PRODUCTS SALES
TRUSS OR GIRDER	BARNEHOUSE-GENERAL (IF GOVERNMENT AND STATE OR FEDERAL)
CANTILEVER BRIDGE	GRAIN ELEVATOR
COVERED BRIDGE	C. C. STORAGE PLANT
HIGHWAY GRADE SEPARATION	GREENHOUSE
MISCELLANEOUS STRUCTURES	NURSERY
DAM WITH ROAD	STOCK YARD-LOADING PEN OR CORRAL
LEVEE OR DIKE	STOCK PEN AT RAILROAD SIDING (SMALL)
CONCRETE FORD OR DIP	QUARRY
FORD-ROAD ESTABLISHED	RIKIN OR OTHER LINE (CLIFF PRODUCTIONS, COKE, ETC.)
CATTLE GUARD	EDUCATIONAL AND CORRECTIONAL INSTITUTIONS
GATE ACROSS ROAD	SCHOOLHOUSE
STATE	CONSOLIDATED OR LARGE SCHOOL
COUNTY	TOWNHALL, GRANGE, OR COMMUNITY HALL
CORPORATE LINES	AGRICULTURAL EXPERIMENT STATION
BOUNDARY LINES ESTABLISHED FOR DELIMITED URBAN PLACES	COUNTY FARM
SECTION LINE	CORRECTIONAL INSTITUTION
MATCH LINE BETWEEN ADJOINING SHEETS OF SAME COUNTY	PUBLIC SERVICE FACILITIES
BOUNDARY TO MARK ENLARGEMENT INSET	POST OFFICE
PARKS AND OTHER RESERVATIONS NATIONAL, STATE, COUNTY, OR MUNICIPAL PARK, INDIAN RESERVATION, NATIONAL MONUMENT, FEDERAL DEVELOPMENT PROJECT, MONUMENT-SMALL, HISTORIC SITE	HIGHWAY GARAGE
CITY AND VILLAGE CENTERS	FIRE ENGINE HOUSE
STATE CAPITAL	GARAGE OR RUBBISH DUMP
COUNTY SEAT	WATER SUPPLY, STAND PIPE, OR TANK
OTHER CITIES AND VILLAGES	PIPE LINE, GAS
BOUNDARY LIMITS FIXED FOR SPECIAL TAXING AREAS AND OTHER UNINCORPORATED URBAN PLACES DELIMITED	PIPE LINE, OIL
	PIPE LINE, PRODUCTS
	TRANSMISSION LINE (WITH TRANSFORMER)
	POWER PLANT
	POWER SUBSTATION
	BOOSTER STATION
	UNDERGROUND TELEPHONE OR RADIO CABLE
	RADIO STATION (WITH CALL LETTERS)
	RADIO RANGE STATION
	MISCELLANEOUS
	FORT, ARMY CAMP, BARRACKS, OR OTHER MILITARY POST
	TRIANGULATION STATION
	BENCH MARK (WITH ELEVATION)
	PROMINENT ELEVATION WITH NAME
	NATURAL FEATURES
	WATER COURSE
	SINK OR DEPRESSION

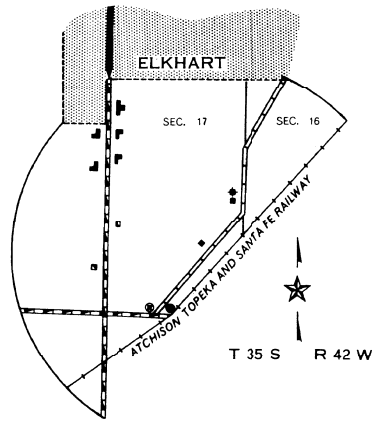
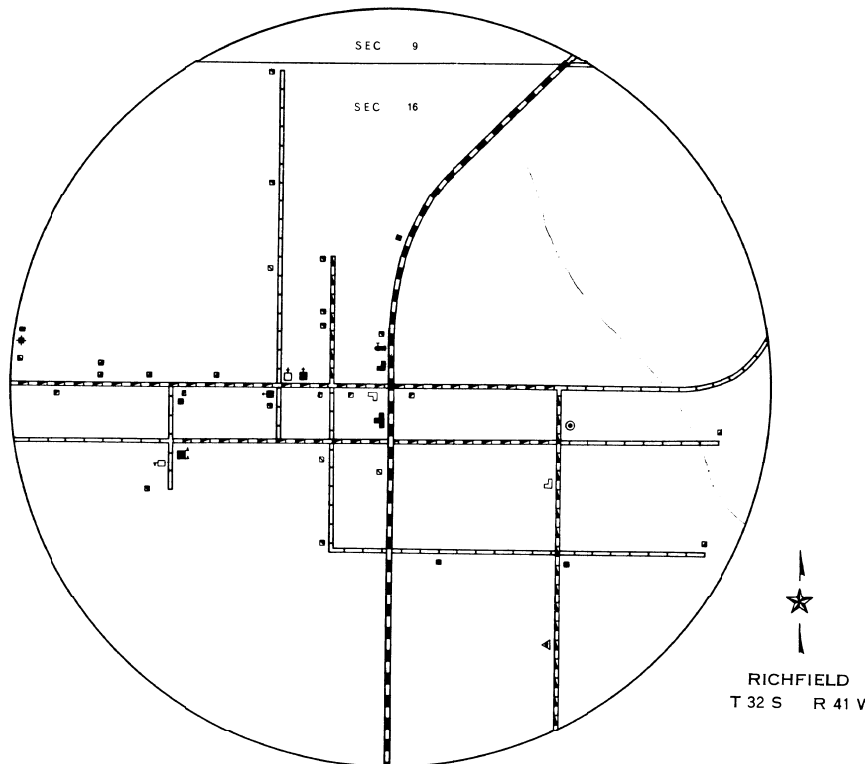
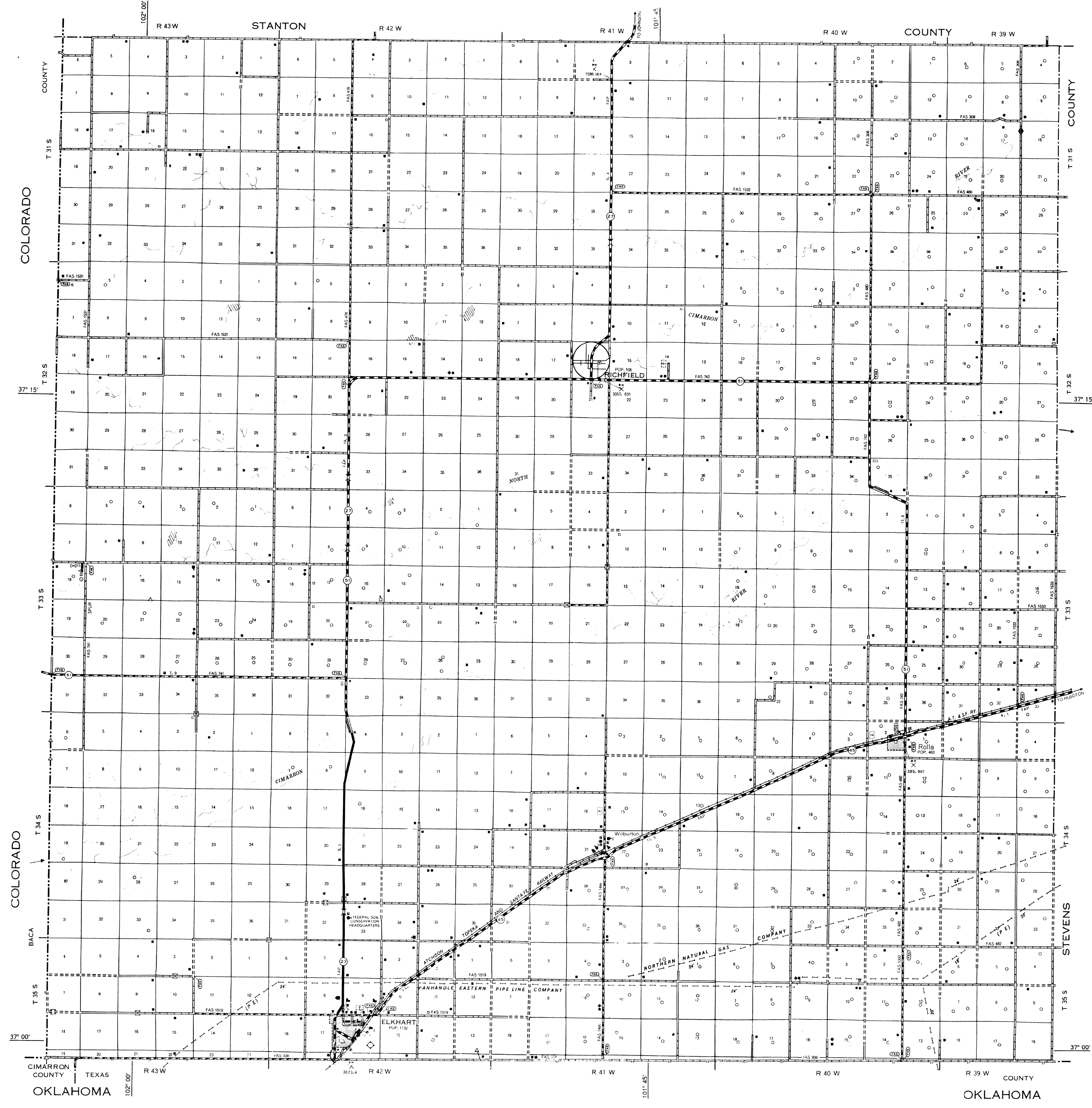

GENERAL HIGHWAY MAP MORTON COUNTY KANSAS

PREPARED BY THE
STATE HIGHWAY COMMISSION OF KANSAS
HIGHWAY PLANNING DEPARTMENT
IN COOPERATION WITH THE
U. S. DEPARTMENT OF COMMERCE
BUREAU OF PUBLIC ROADS

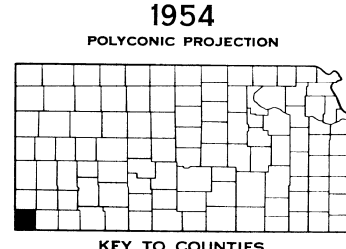
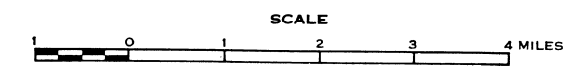

STATISTICAL DATA FROM AERIAL PHOTOGRAPHS BY U. S. DEPARTMENT OF AGRICULTURE SOIL CONSERVATION SERVICE