



PAVEMENT RECONSTRUCTION

U.S. 69 TO METCALF AVENUE | FEBRUARY 2017



The Kansas Department of Transportation continually strives to maintain and improve its highways across Kansas. Numerous portions of I-435 have been widened as part of the I-435/U.S. 69 project and the Johnson County Gateway Phase 2 project, but some pavement from just west of U.S. 69 to Metcalf Avenue is over 30 years old and needs to be replaced.

Starting in March 2017, pavement reconstruction will begin on I-435 from a half-mile west of U.S. 69 to just east of Metcalf Avenue. Project work includes removal of existing deteriorated pavement and replacing it with new concrete pavement. In addition, project work includes bridge deck patching and resurfacing, and reconstruction of approach slabs for the bridges over Indian Creek and Metcalf Avenue. The northbound U.S. 69 to westbound I-435 loop ramp and a portion of the westbound I-435 collector-distributor road (C-D) will also receive a facelift with a new asphalt overlay. Clarkson Construction Company (Kansas City, MO) is the primary contractor on this \$16.34 million pavement reconstruction project.

The I-435 pavement reconstruction project will take two construction seasons and is scheduled to be completed by mid-November 2018, weather permitting.

2017 Construction Season (March – November)

Eastbound I-435 lanes reconstructed. Both eastbound and westbound I-435 lanes will be reduced to THREE through lanes and shifted to the north. Two eastbound through lanes will be crossed over onto the westbound pavement. This will be a similar configuration that occurred on I-435 during the Johnson County Gateway project in 2015-2016. The remaining eastbound through lane and auxiliary lane will then shift to the north while the outermost portion of the eastbound reconstruction is completed. There will be a traffic shift to the south to complete the innermost eastbound reconstruction. There will be:

- 21-day closures of Antioch Road eastbound I-435 on/off ramps.
- Lane reductions on westbound I-435 on/off to Quivira Road ramp.
- Various traffic shifts as work progresses.
- Posted speed limit of 55 mph through project work zone

2018 Construction Season (March – Mid-November)

Westbound I-435 lanes reconstructed. Both eastbound and westbound I-435 lanes will be reduced to THREE through lanes and shifted to the south. Two westbound through lanes will be crossed over onto eastbound pavement. The remaining westbound through lane and auxiliary lane will be shifted south for the outermost reconstruction. There will be a traffic shift north to complete the innermost reconstruction. There will be:

- Lane reductions for westbound on/off ramps.
- 21-day closures of Antioch Road westbound I-435 on/off ramps.
- Lane reductions on eastbound I-435 to Antioch Road on/off ramp.
- Various traffic shifts as work progresses.
- Posted speed limit of 55 mph through project work zone.

TRAFFIC IMPACTS

Nearly 140,000 vehicles a day travel through this portion of I-435. Drivers may experience additional delays of 10-15 minutes through the work zone under normal traffic conditions. Both eastbound and westbound I-435 from U.S. 69 to Metcalf Avenue will be reduced to THREE through lanes of traffic. Traffic will be shifted and crossed over in order to maintain traffic flow and complete the pavement reconstruction work.



CONSTRUCTION SCHEDULE

2017 Construction Season: Eastbound I-435 Lanes

Early Spring: Construct temporary crossovers. Close eastbound and westbound far left lanes. Get ready for new traffic shift configuration.

Spring/Summer: Construct outer lane pavement replacement between U.S. 69 and Metcalf Avenue.

- Short-term closures: Eastbound I-435 to Antioch Road ramp and Antioch Road to eastbound I-435 ramp will be closed for up to 21 days during this timeframe. Both ramps will not be closed at the same time. Detour routes will be signed.

Late Summer/Fall: Construct inside lane pavement replacement.

Fall: Construct temporary pavement widening near westbound I-435 and Metcalf Avenue ramp.

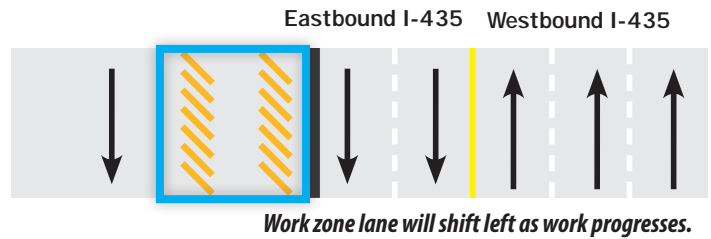
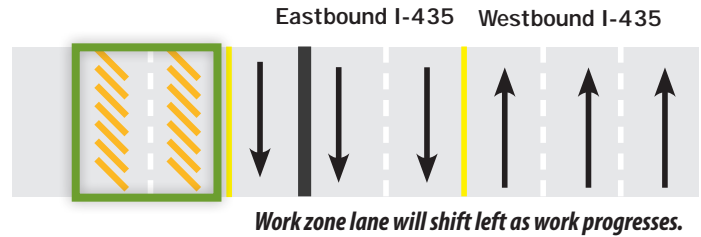

2018 Construction Season: Westbound I-435 Lanes

Winter/Spring: Construct temporary pavement widening near westbound I-435 and Metcalf Avenue ramp. Traffic shift will occur.

Spring/Summer: Construct outer lane pavement replacement between U.S. 69 and Metcalf Avenue.

- Short-term closures: Westbound I-435 to Antioch Road ramp and Antioch Road to westbound I-435 ramp will be closed for up to 21 days during this timeframe. Both ramps will not be closed at the same time. Detour routes will be signed.

Summer/Fall: Construct inside lane pavement replacement.

Fall: Remove temporary pavement and reconstruct the median. Shift traffic back to normal configuration.

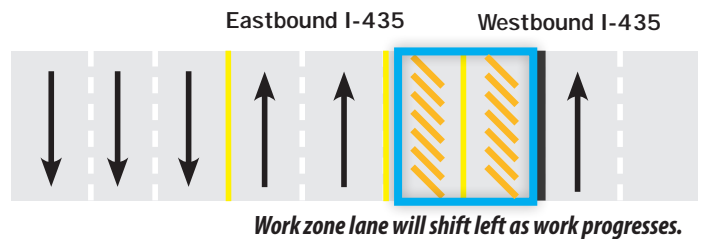
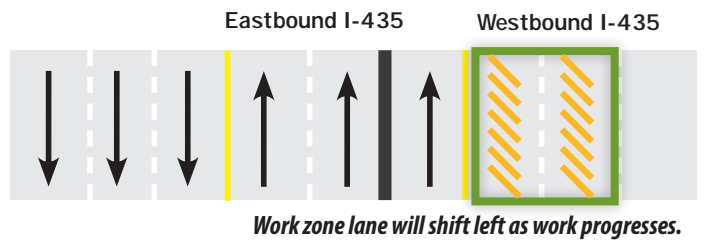

STAY INFORMED OF TRAFFIC IMPACTS

Know before you go. Stay updated on traffic impacts:

Advance & Daily Info:



www.ksdot.org/bureaus/kcMetro

@KansasCityKDOT

KDOT Northeast Kansas

Johnson County Gateway

Real-time Traffic:

www.kscout.net

For more information contact:

Kimberly Qualls
 KDOT
 Public Affairs Manager
 785-640-9340
Kimberly.Qualls@ks.gov