



7400 West 129th Street, Suite 100 | Overland Park, KS 66213 | www.69express.org | info@69express.org



IMMEDIATE RELEASE

Oct. 20, 2023

For more information:

Delaney Tholen
785-817-9365
delaney.tholen@ks.gov

Northbound U.S. 69 segment will close Sunday overnight in Johnson County

On Sunday, Oct. 22, at 5 p.m., northbound U.S. 69, from Blue Valley Parkway to 119th Street, will be **fully closed to traffic** and will reopen at 6 a.m. Monday, Oct. 23, weather permitting.

This temporary closure is part of the Kansas Department of Transportation U.S. 69 expansion project (69Express) and is necessary to allow bridge girder setting work and ramp construction.

During the closure, the following detour will be marked:

- **Northbound U.S. 69 traffic will be directed to exit at Blue Valley Parkway and turn west onto 119th Street, then to the northbound U.S. 69 entrance ramp.**

The 69Express project includes reconstruction of U.S. 69, widening the highway with added tolled express lanes – one in each direction between 151st and 103rd Streets – and interchange improvements at U.S. 69/167th Street in Overland Park.

Map below shows closure location marked in red and detour route marked in blue.

69 EXPRESS

7400 West 129th Street, Suite 100 | Overland Park, KS 66213 | www.69express.org | info@69express.org

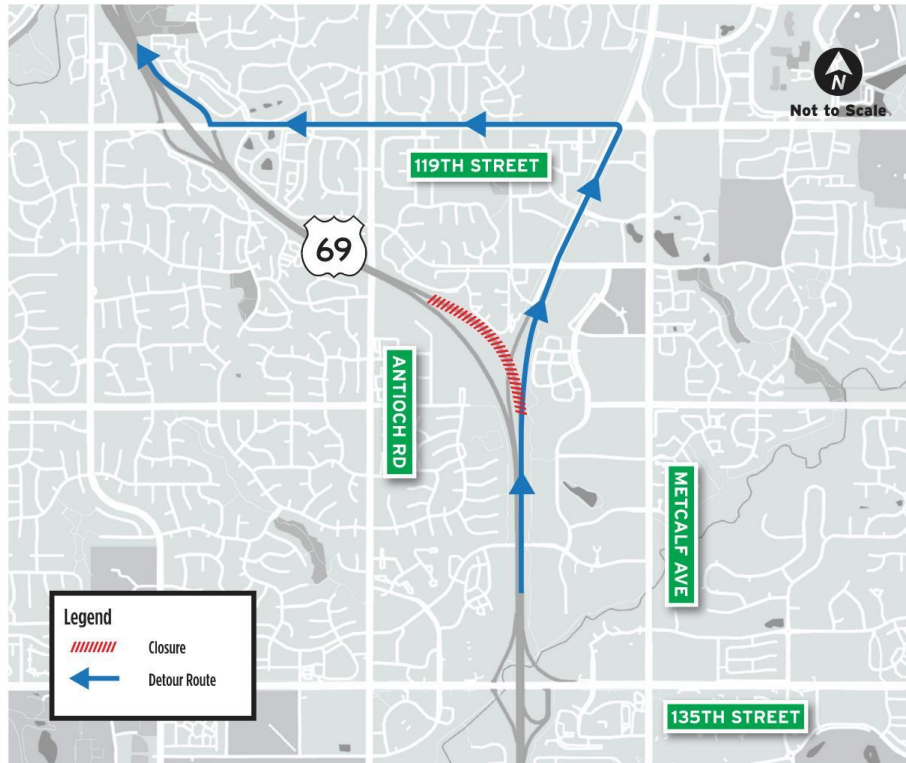

All current 69Express construction and closure information is available on the project website, www.69express.gov. For additional information, members of the public can get regular construction updates on the project [Facebook](#) and [X \(formerly Twitter\)](#) pages, and by [subscribing to the project newsletter](#) and [signing up for text alerts](#).

###

This information can be made available in alternative accessible formats upon request. For information about obtaining an alternative format, contact the KDOT Division of Communications, 700 SW Harrison St., 2nd Fl. West, Topeka, KS 66603-3745 or phone 785-296-3585 (Voice) / 7-1-1 (Hearing Impaired).

Click below to connect to KDOT's Social Networks:

